

483 - 2 GRAVE LOTS
 77 - 3 GRAVE LOTS
 4 - 8 GR. MON. LOTS
 TOTAL 564 LOTS

CALVARY CEMETERY.
 EAST PART OF
SECTION 74.

Scale 1"=20'
 E.J.M. June 16, 1943
 NUMBERED LOT MARKERS ARE LOCATED IN THE LOT
 AND GRAVE MARKERS ARE LOCATED AS INDICATED
 BY ARROWS. ALL LOTS ARE 2 GRAVE LOTS EXCEPT WHERE OTHER-
 WISE NOTED.

ALL 3 GRAVE LOTS ARE 6'x9'
 REV. 1952 E.J.M.

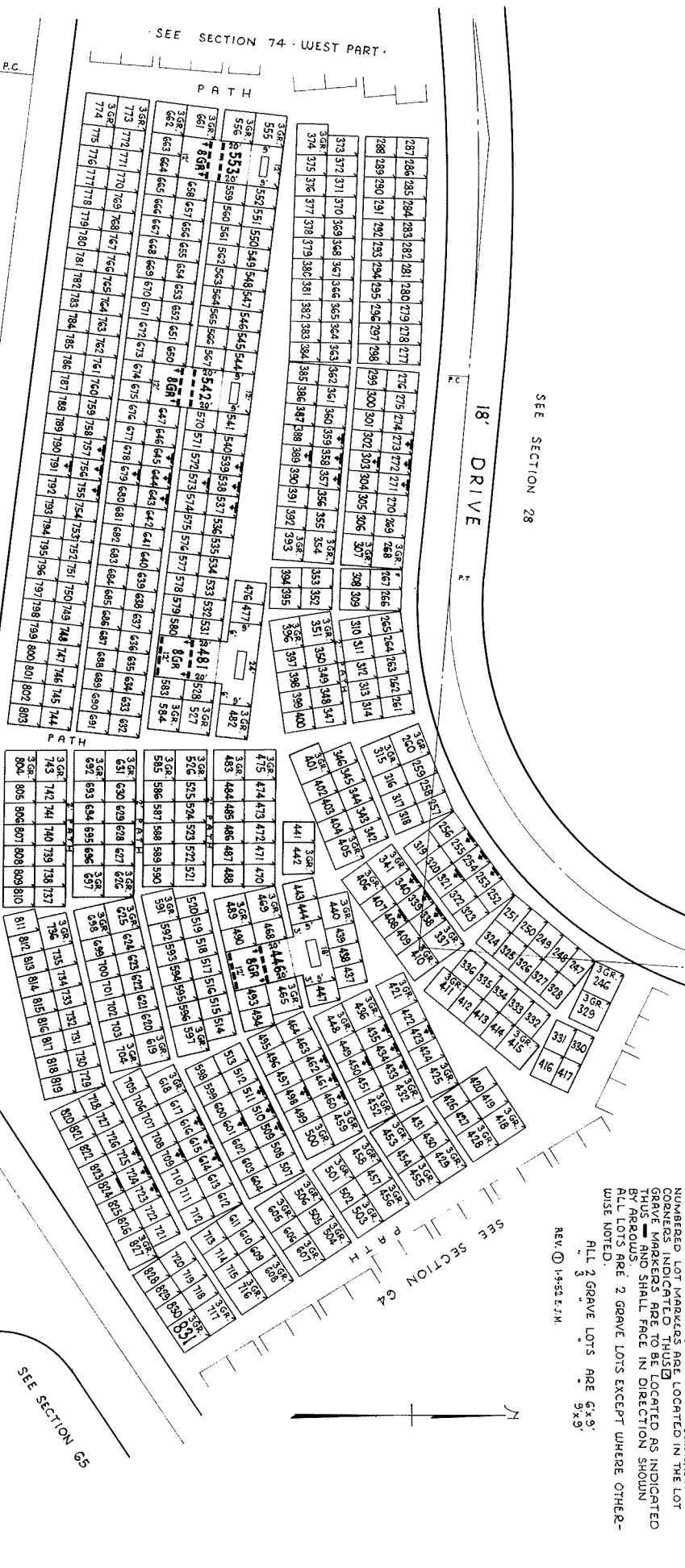

SEE SECTION 74 - WEST PART.

SEE SECTION 28

SEE SECTION 75

SEE SECTION 76

SEE SECTION 75

235 - 2 GRAVE LOTS
 10 - 3 GRAVE LOTS
 TOTAL 245 - LOTS

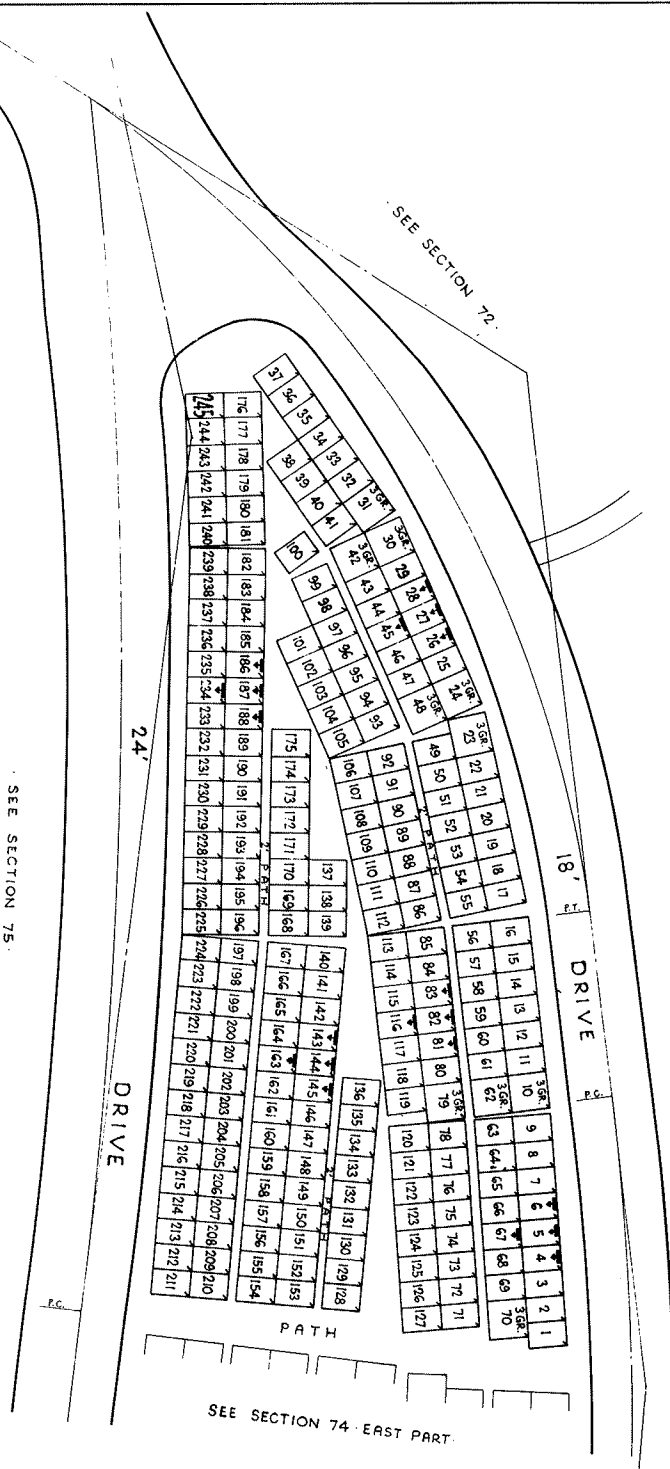

SEE SECTION 28.

SEE SECTION 75.

SEE SECTION 74 - EAST PART.

CALVARY CEMETERY.
 WEST PART OF
SECTION 74

Sale 1"-=20' E.A.M. June 3, 1949
 NUMBERED LOT MARKERS ARE LOCATED IN THE LOT
 CORNERS INDICATED THUS GRAVE
 MARKERS ARE TO BE LOCATED AS INDICATED
 THUS AND SHALL FACE IN DIRECTION SHOWN
 BY ARROWS.
 ALL LOTS ARE 2 GRAVE LOTS EXCEPT WHERE OTHER-
 WISE NOTED.
 ALL 2 GRAVE LOTS ARE 6'x9'
 " 3 " 9'x9'